

O-I Manufacturing France
 64 bd du 11 Novembre 1918 - BP 1228
 69611 Villeurbanne Cedex, France
 Tel. +33 (0)426686500

CONTAINER & MOULD ENGINEERING
EUROPE

NOTES:
 THIS DRAWING IS THE PROPERTY OF O-I AND
 MUST NOT BE REPRODUCED OR DISCLOSED
 WITHOUT O-I WRITTEN AUTHORIZATION.

ONLY TOLERANCED DIMENSIONS ARE GUARANTEED.

MANUFACTURING MARKINGS SHOWN ARE FOR ILLUSTRATIVE
 PURPOSES ONLY, ACTUAL MARKINGS ON CONTAINER
 MAY DIFFER, DEPENDANT ON LOCAL LEGISLATION.

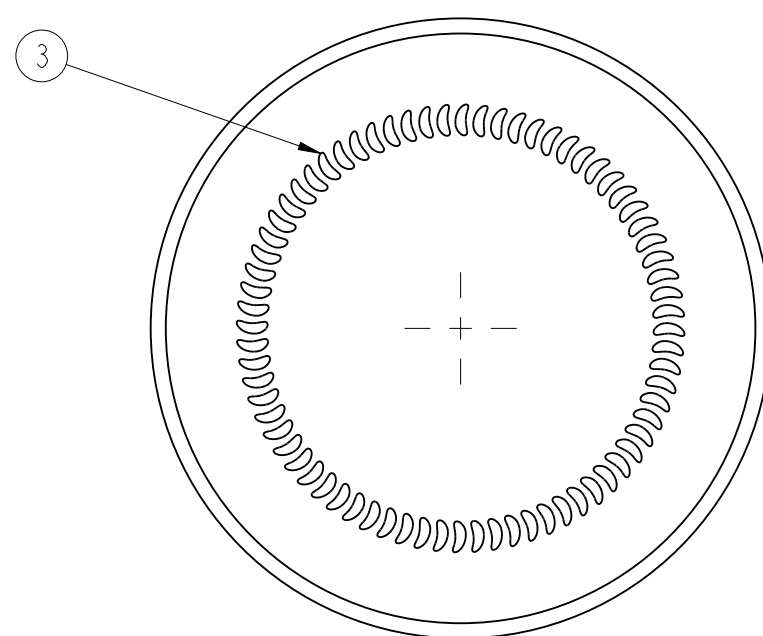
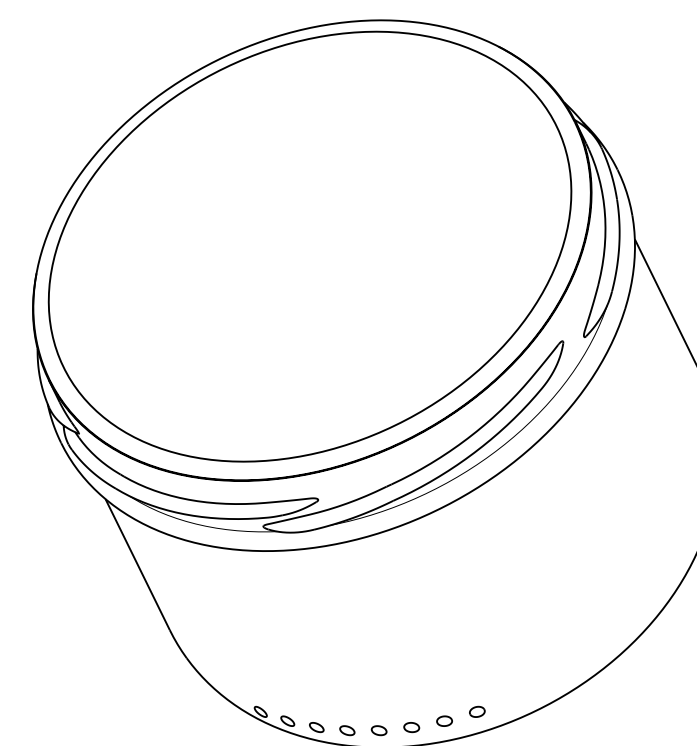
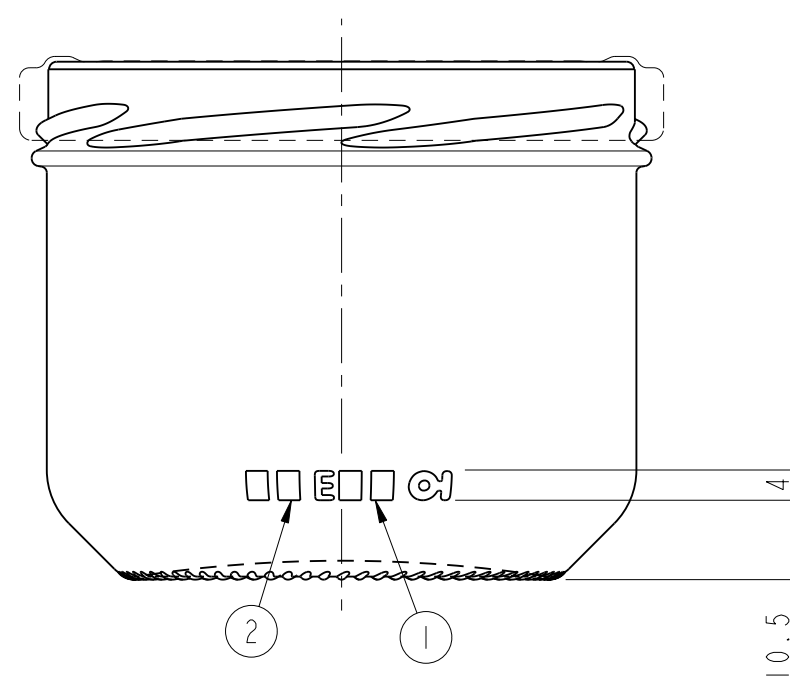
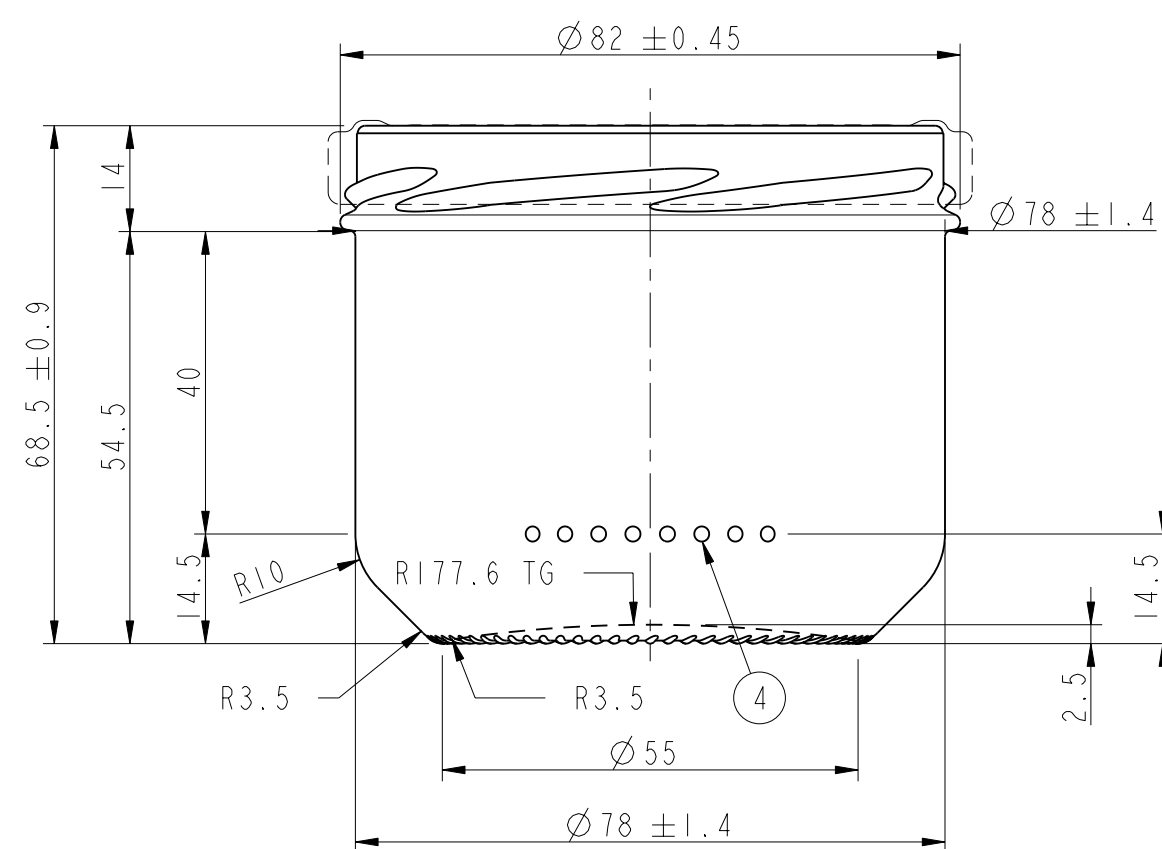

1 = TRADEMARK
 2 = CAVITY No.
 3 = STIPPLING
 THE SHAPE OF STIPPLES IS ONLY AN
 INDICATION AND THE CONSTRUCTION IS AT
 THE PRODUCTION PLANT DISCRETION.
 4 = CAVITY CODE

SCALE 1:1

HEAT TREATMENT XX °C maxi	CARBONATION XX g CO ₂ /l maxi	
VERTICAL LOAD 150 daN maxi	THERMAL SHOCK 42 °C maxi	
CATEGORY FOOD	TILT ANGLE 40.69°	
MAX. VERTICALITY TOLERANCE 1.5 mm	MEASURING CONTAINER NO	
FINISH SAP NUMBER 3746	FINISH REF. CETIE GME 20-09 1995	
MINIMUM THROUGH BORE mm	MAX FILLING TUBE Ø mm	
CONTAINER OVERFLOW CAPACITY (BRIMFUL) 262ml ± 6ml		
CONTAINER RATED CAPACITY (FILLPOINT) NA		
CONTAINER WEIGHT 125g APPROX.		
FINISH DESIGNATION FR_82_GME 20-09_H140_3746	MAX GAS VOLUME	
PROCESS	RETURNABLE NO	DESIGN REF. 14_2601

STANDARD
262 ML VERRINE TO 82

DESIGNER	BCO	DATE	27/06/11
CHECKED		DATE	
DRAWING NUMBER 110476		MOULD/SAP NUMBER 013441	

No	DATE	REVISIONS	DESIGN/CHECK
	27/06/11	REPRISE KBE ANNULE & REMPLACE N°PLAN 6105-01 B	BCO